

**General Notes**

- ① T = Slab thickness.
- ② Begin placing deformed rebar and/or smooth bars beginning 6 inches [150] from the edge of pavement or as specified. For longitudinal joints, place rebar perpendicular to joints, for transverse joints, place rebar parallel to the direction of travel.
- ③ When transverse joints do not fracture in the joint at the edge of the slab, saw depth may be increased as approved by the engineer at no additional cost to the department.
- ④ Some joint sealants such as liquid joint sealants may require a 3/16" [5] final joint width. For those conditions it is acceptable to make the initial saw cut width 3/16" [5].
- ⑤ Type K, Pavement-Thru Expansion Joints including the required sleeper slab and appurtenances may be substituted for Type E Expansion Joints at the contractor's expense. Provide 24 Gauge [0.7 thick] galvanized sheeting that meets the requirements of ASTM A653, coating designation G90. Cover the entire sleeper slab with the sheeting, acting as a bond breaker. Saw cut or form a full depth joint 1-1/2 inches [38] wide. Do not cut into the galvanized sheet.

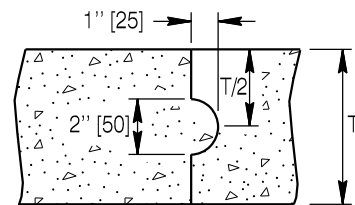

**ALTERNATE KEYWAY DETAIL**

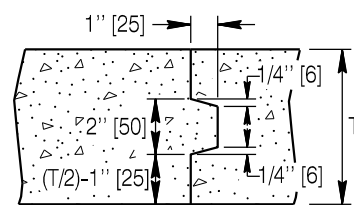

**TYPICAL KEYWAY DETAIL**

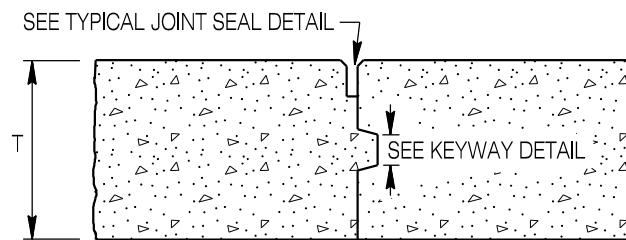

**TYPE B KEYED CONSTRUCTION JOINT**

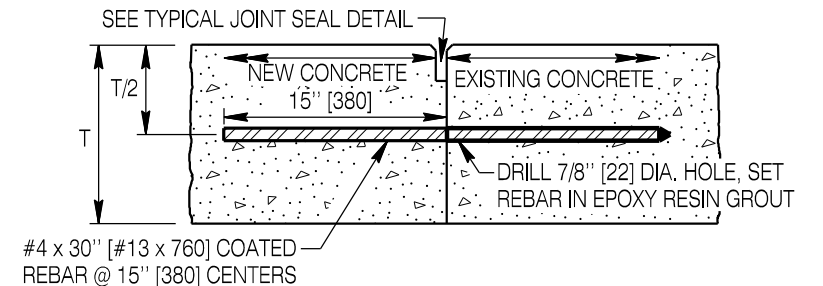

**TYPE F TYING TO EXISTING CONCRETE**

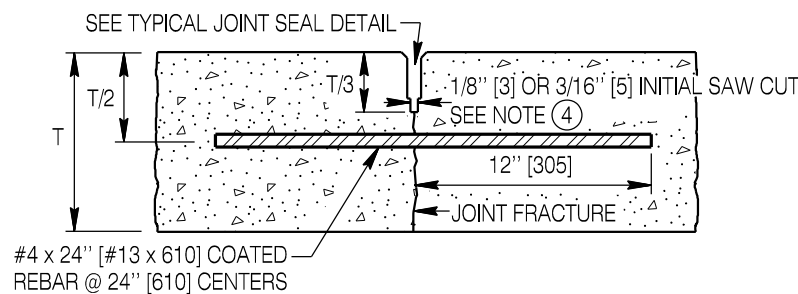

**TYPE X TIED WEAKENED PLANE JOINT**

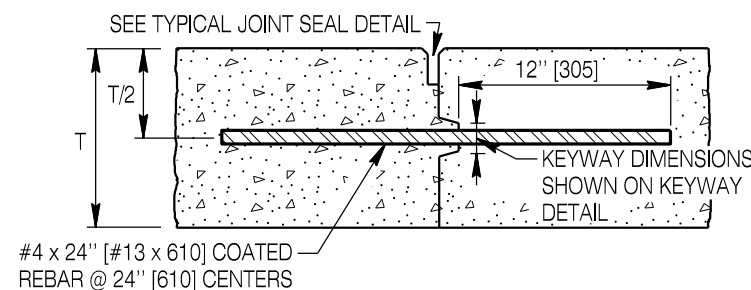

**TYPE Y CONSTRUCTION JOINT**

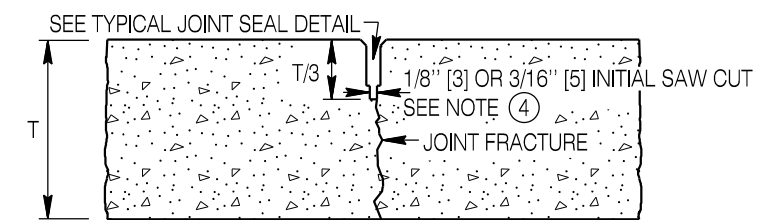

**TYPE Z WEAKENED PLANE JOINT**

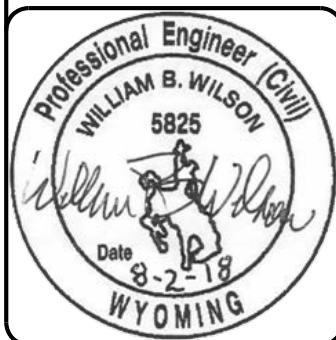

Designed by: WBW  
 Drawn by: RCS/JK  
 Checked by: WBW  
 Previous Dwg. No. 414-1A

**LONGITUDINAL JOINT DETAILS**

Note: Units shown in brackets [ ] are metric and are in millimeters (mm) unless other units are shown.



**CONCRETE PAVEMENT JOINTS**

STANDARD PLAN

STANDARD PLAN NUMBER  
**414-2**  
 SHEET 1 of 3  
 Issued by: ENGINEERING SERVICES  
 Date Issued: OCTOBER 2018

**Note:** See keyed notes (X) for joint construction on sheet 1, and keyed notes (A) for joint seal on sheet 3.

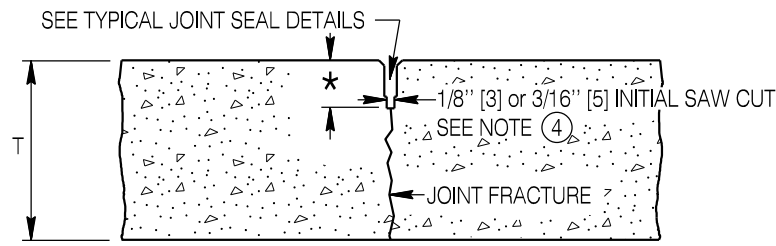

\* SLAB THICKNESS 10" [250] OR LESS: T/4  
SLAB THICKNESS MORE THAN 10" [250]: T/3.

**TYPE (A) WEAKENED PLANE JOINT**

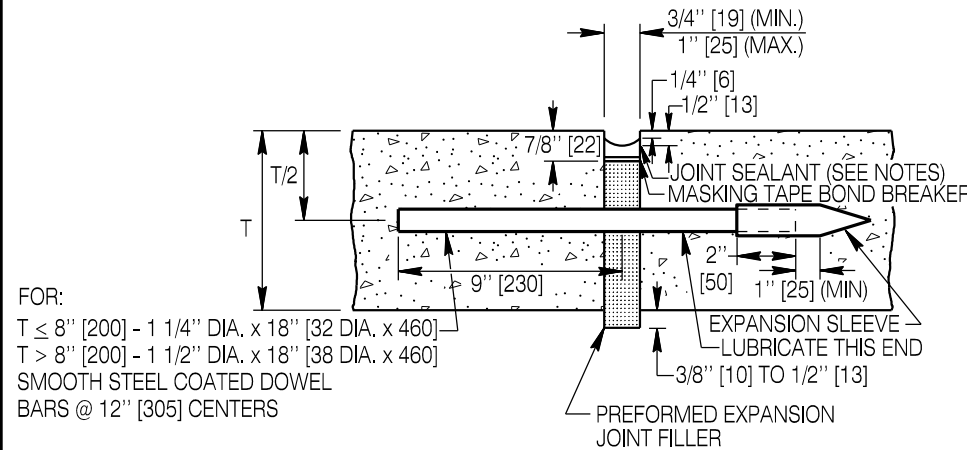

FOR:  
T ≤ 8" [200] - 1 1/4" DIA. x 18" [32 DIA. x 460]  
T > 8" [200] - 1 1/2" DIA. x 18" [38 DIA. x 460]  
SMOOTH STEEL COATED DOWEL  
BARS @ 12" [305] CENTERS

**TYPE (E) EXPANSION JOINT**

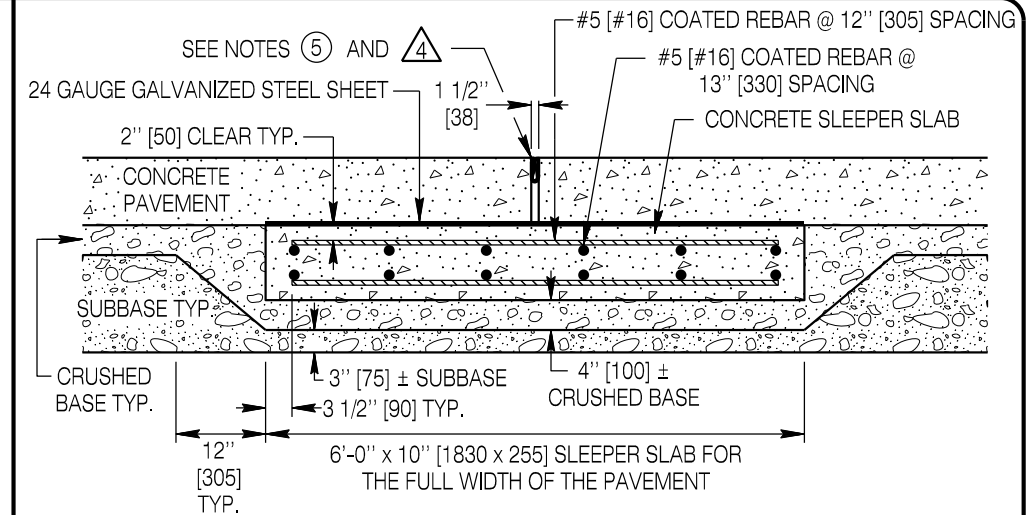

**TYPE (K) PAVE-THRU EXPANSION JOINT DETAIL**

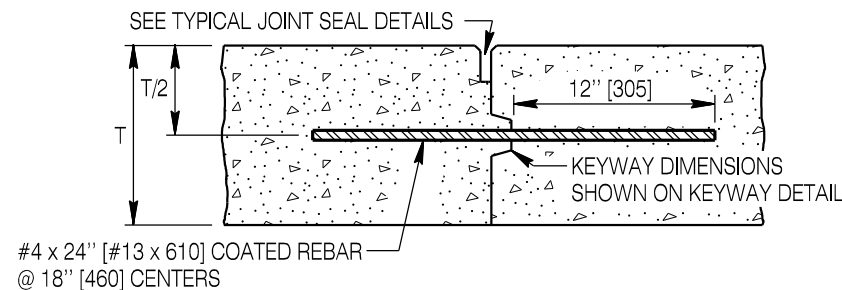

#4 x 24" [#13 x 610] COATED REBAR @ 18" [460] CENTERS

**TYPE (C) CONSTRUCTION JOINT**

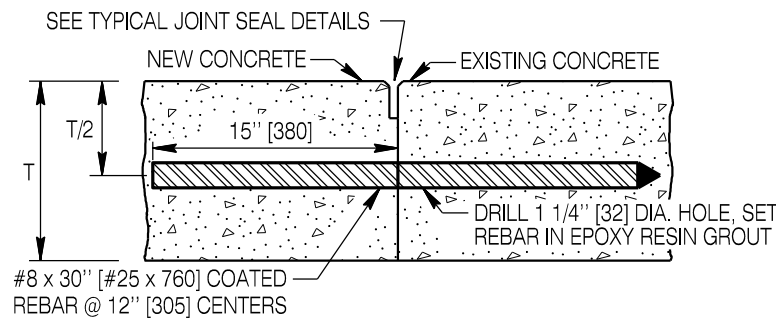

#8 x 30" [#25 x 760] COATED REBAR @ 12" [305] CENTERS

**TYPE (G) SLAB REPLACEMENT TRANSVERSE JOINT (NOT AT EXISTING JOINT)**

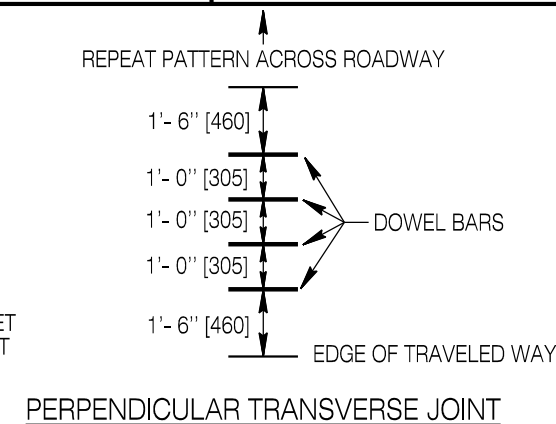

**PERPENDICULAR TRANSVERSE JOINT**

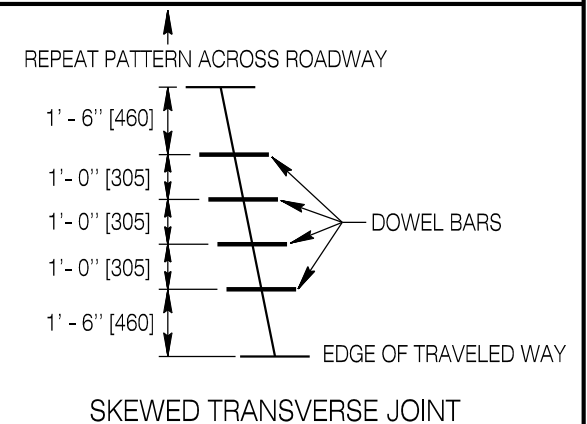

**SKewed TRANSVERSE JOINT**

**Note:** Only for repairs in existing pavements with skewed joints.

REBAR SPACING FOR TYPE (G)  
TRANSVERSE JOINT

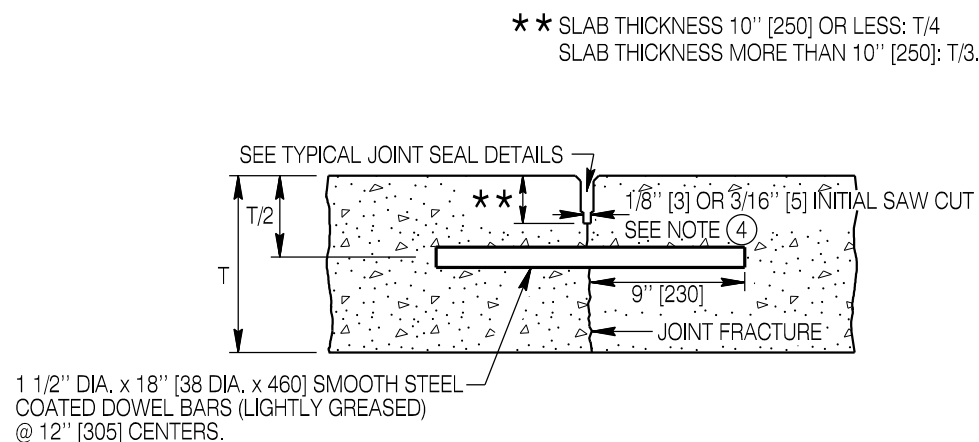

\*\* SLAB THICKNESS 10" [250] OR LESS: T/4  
SLAB THICKNESS MORE THAN 10" [250]: T/3.

1 1/2" DIA. x 18" [38 DIA. x 460] SMOOTH STEEL COATED DOWEL BARS (LIGHTLY GREASED) @ 12" [305] CENTERS.

**TYPE (D) TRANSVERSE DOWELED WEAKENED PLANE JOINT**

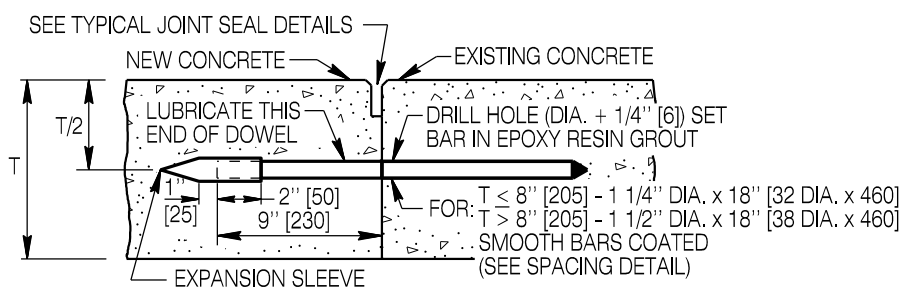

FOR:  
T ≤ 8" [205] - 1 1/4" DIA. x 18" [32 DIA. x 460]  
T > 8" [205] - 1 1/2" DIA. x 18" [38 DIA. x 460]  
SMOOTH BARS COATED (SEE SPACING DETAIL)

**TYPE (J) SLAB REPLACEMENT TRANSVERSE JOINT (AT EXISTING JOINT)**

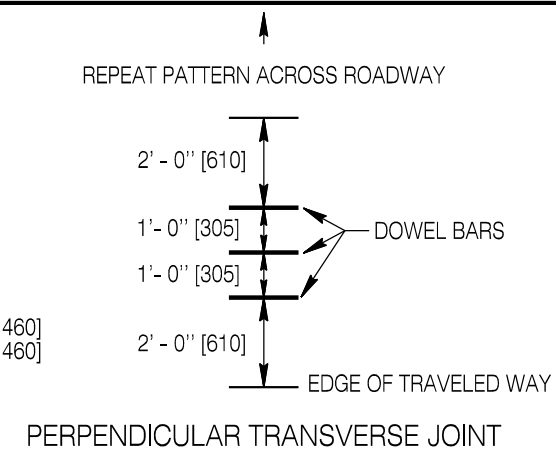

**PERPENDICULAR TRANSVERSE JOINT**

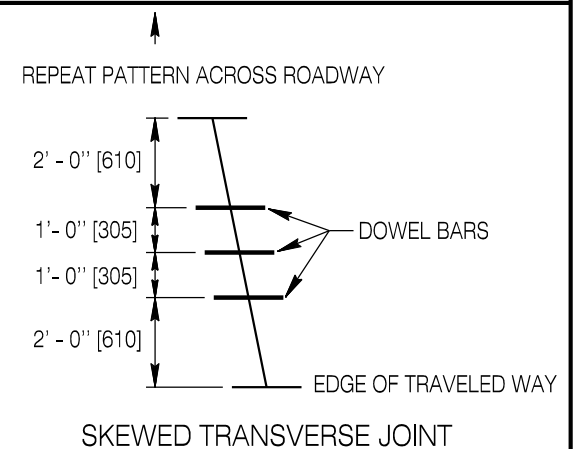

**SKewed TRANSVERSE JOINT**

**Note:** Only for repairs in existing pavements with skewed joints.

DOWEL SPACING FOR TYPE (J)  
TRANSVERSE JOINT

Designed by: WBW  
Drawn by: RCS/JJK  
Checked by: WBW  
Previous Dwg. No. 414-1A

TRANSVERSE JOINT DETAILS

Note: Units shown in brackets [ ] are metric and are in millimeters (mm) unless other units are shown.



WYOMING DEPARTMENT OF TRANSPORTATION



CONCRETE PAVEMENT JOINTS

STANDARD PLAN

STANDARD PLAN NUMBER

414-2

SHEET 2 of 3

Issued by: ENGINEERING SERVICES  
Date Issued: OCTOBER 2018

**Joint Seal Notes**

- 1 Use the joint sealant type as specified in the contract.
- 2 Seal type "E" joints with silicone seal.
- 3 Tape or close joint ends as approved by the engineer to prevent loss of joint sealant.
- 4 Seal Type K Pave-Thru Expansion Joints with a compression joint material which is closed-cell, cross-linked, low-density polyethylene copolymer, nitrogen blown resilient foam material with an ultraviolet stabilizer. Recess the compressed joint material 1/4 inch [6] below the top of the concrete pavement. Splices shall be beveled 45 degrees and butted together.

**NON-SAG SILICONE SEALANT JOINT DIMENSIONS**

ORIGINAL SAW CUT		"A" WIDTH OF SAW CUT		"B" DEPTH OF SAW CUT		"C" SEALANT THICKNESS		"D" BACKER ROD DIAMETER	
IN	mm	IN	mm	IN	mm	IN	mm	IN	mm
LESS THAN 3/8	10	3/8	10	1 1/2	38	1/4	6	1/2	13
3/8	10	1/2	13	1 1/2	38	1/4	6	5/8	16
1/2	13	5/8	16	1 3/4	44	5/16	8	3/4	19
5/8	16	3/4	19	2	50	3/8	10	1	25
3/4	19	7/8	22	2	50	7/16	11	1	25
7/8	22	1	25	2 1/4	57	1/2	13	1 1/4	32
FROM 1 to 2	FROM 25 to 50	ORIGINAL WIDTH PLUS 1/8" [3]		DIM. "A" PLUS 1 1/2" [38]		1/2	13	DIM. "A" PLUS 1/8" [3]	

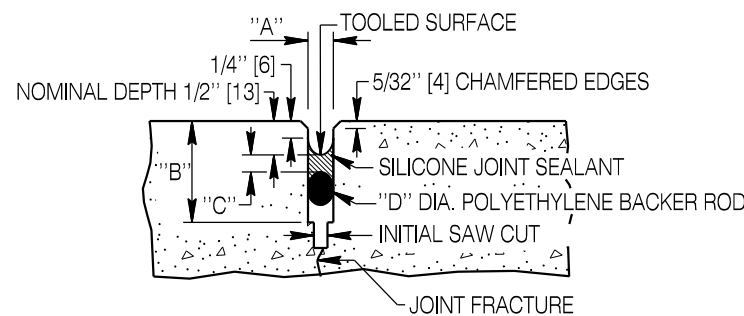

**NON-SAG SILICONE SEALANT JOINT**  
For variable dimensions see table

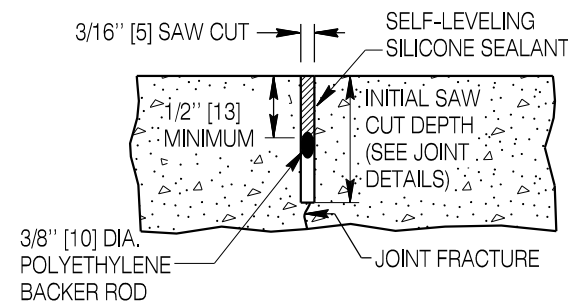

**SELF-LEVELING SILICONE SEALANT JOINT**

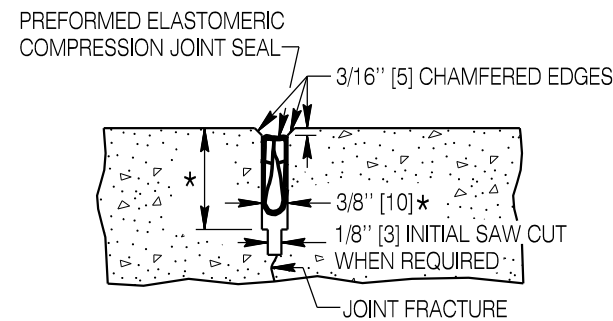

\* MAKE DEPTH OF 3/8" [10] SAW CUT IN ACCORDANCE WITH JOINT SEAL MANUFACTURER'S RECOMMENDATIONS.

**PREFORMED ELASTOMERIC COMPRESSION JOINT SEAL**

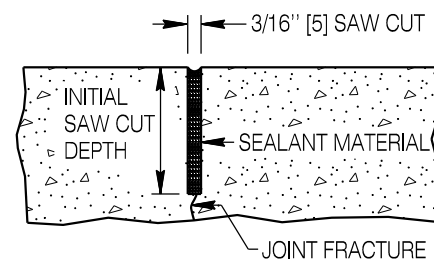

**HOT POURED ELASTIC JOINT SEAL**

**TYPICAL JOINT SEAL DETAILS**

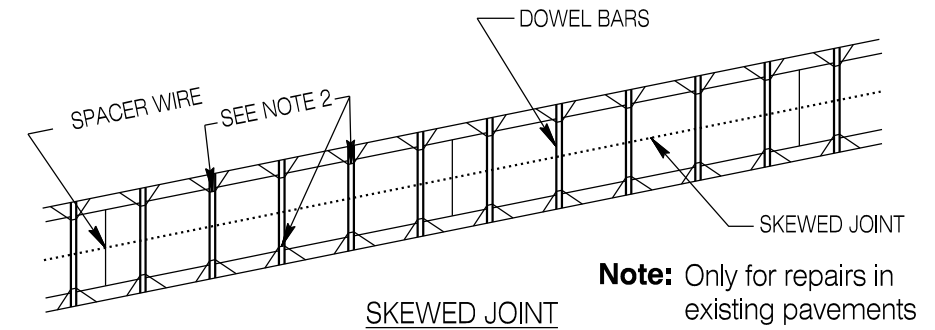
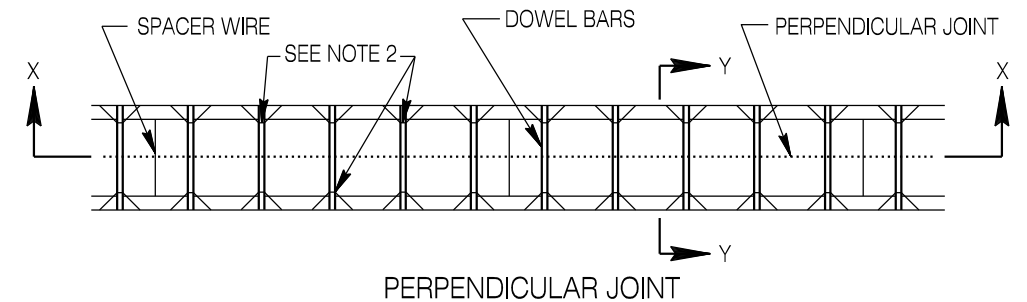

**Note:** Only for repairs in existing pavements with skewed joints.

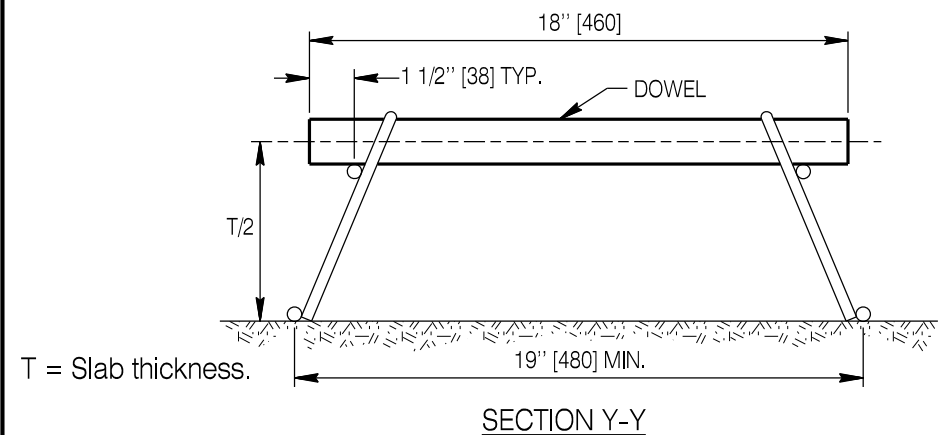
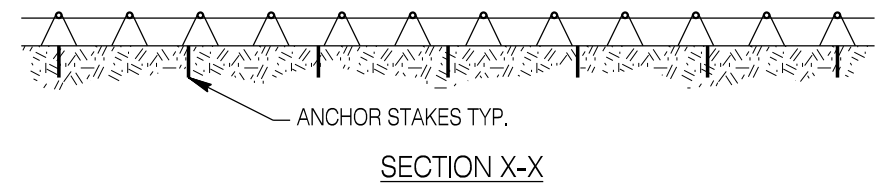

**TYPICAL PLAN OF TRANSVERSE JOINT DOWEL ASSEMBLY**

**Dowel Basket & Dowel Placement Notes**

- 1. After staking in place, cut spacer wire.
- 2. Tack weld dowel bars at alternating ends to the basket assembly.
- 3. Do not crush dowel baskets.

Designed by: WBW  
Drawn by: RCS/JJK  
Checked by: WBW  
Previous Dwg. No. 414-1A

**TRANSVERSE JOINT DOWEL ASSEMBLY AND JOINT SEAL DETAILS**

Note: Units shown in brackets [ ] are metric and are in millimeters (mm) unless other units are shown.



**CONCRETE PAVEMENT JOINTS**

STANDARD PLAN

STANDARD PLAN NUMBER  
**414-2**  
SHEET 3 of 3  
Issued by: ENGINEERING SERVICES  
Date Issued: OCTOBER 2018